

ELEMENT™ LIGHTED MIRROR

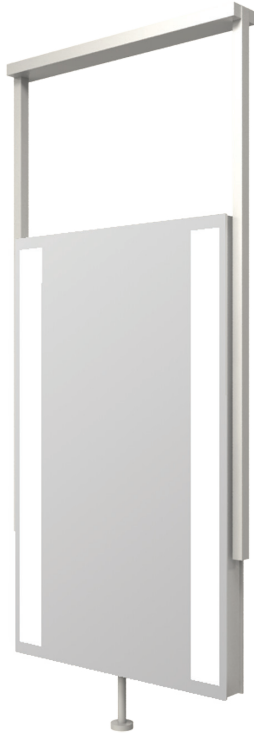

The Element™ Lighted Mirror is an innovative design creating a unique lighted mirror opportunity for an unconventional space, suspended from the ceiling in a stainless steel frame with two vertical bands of natural even light.

FEATURES

- E-Life™-8 Years Extended Lamp Replacement Cycle
- Brushed or Polished Stainless Steel Frame
- Reverse Side is Full Mirror
- Natural Light Color
- HardCoat™ Anti-Corrosion Mirror Treatment
- Stainless Steel Construction
- Environmentally Sustainable
- Energy Efficient
- Proudly Made in The USA

LIGHTING

- Low-Mercury T5HO Warm Fluorescent (US Made)
- CRI 85
- CCT (K) 3000
- Average Lamp life 35,000 Hours
- 50,000 Cycle Ballast

OPTIONS

- Custom Sizes Available
- Add Keen™ Technology
- Add Vive™ Technology
- Diamond Clear™
- Dimmable
- Defogger
- LED Digital Clock
- LED Lighting
- EnergyLite™

SAFETY

- Tested to UL/UL-C 1598 Including Section 16.23
- International Certifications
- Safety Backed Mirror

THERE'S ONLY ONE™ ELECTRIC MIRROR®

Electric Mirror is the global leader in Lighted Mirrors and Mirror TV technology. With unparalleled customer service and amazing innovation, Electric Mirror is the standard of luxury for five-star hotels, upscale commercial projects and designer homes.

PROPRIETARY AND CONFIDENTIAL: The information contained in this specification is the sole property of Electric Mirror®. Any reproduction in part or in whole without written permission from Electric Mirror® is prohibited.

© 2014 ELECTRIC MIRROR®

ELEMENT™ LIGHTED MIRROR

SPECIFICATION

- Fixture is ceiling mounted either 60" or 72" above counter top. Ceiling must be sufficient in strength to handle weight of the entire unit.
- Multiple ceiling mounting slots and counter mounted anchor.
- Power to the unit supplied with MC cable exiting ceiling and entering through chassis knockout.
- Power should be controlled by a light switch.

MODEL NUMBER	DIMENSIONS	POWER REQUIREMENTS	LAMPING
ELE60-24.25x38.38	24.25" W x 38.38" H x 2.5" D: 60" H 616mm x 975mm x 63.5mm	110 - 277 VAC, .70 - .28 Amps, 78W	2 x T5HO, 39W
ELE60-24.25x38.38-PS	24.25" W x 38.38" H x 2.5" D: 60" H 616mm x 975mm x 63.5mm	110 - 277 VAC, .70 - .28 Amps, 78W	2 x T5HO, 39W
ELE72-24.25x38.38	24.25" W x 38.38" H x 2.5" D: 72" H 616mm x 975mm x 63.5mm	110 - 277 VAC, .70 - .28 Amps, 78W	2 x T5HO, 39W
ELE72-24.25x38.38-PS	24.25" W x 38.38" H x 2.5" D: 72" H 616mm x 975mm x 63.5mm	110 - 277 VAC, .70 - .28 Amps, 78W	2 x T5HO, 39W

*Standard finish is brushed stainless steel, polished stainless steel (PS) available

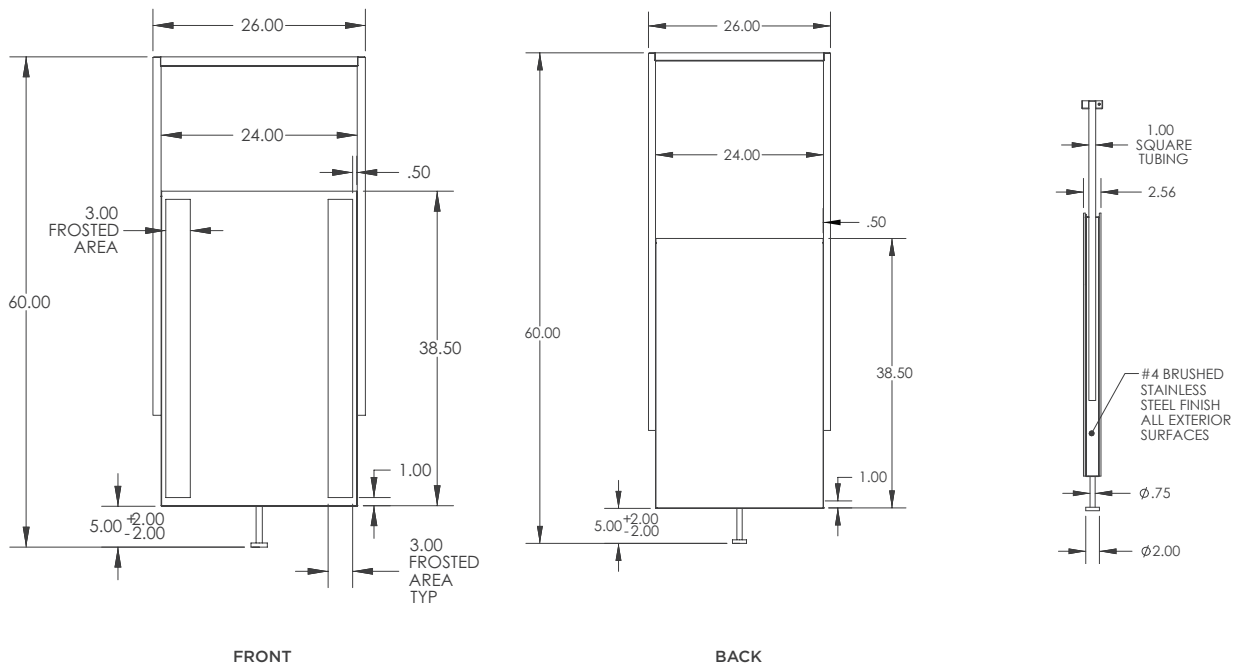

PROPRIETARY AND CONFIDENTIAL: The information contained in this specification is the sole property of Electric Mirror®. Any reproduction in part or in whole without written permission from Electric Mirror® is prohibited.

© 2014 ELECTRIC MIRROR®