

## ELITE™ LIGHTED MIRROR



The Elite™ Lighted Mirror has a romantic shape and glow, suspended from the ceiling in a stainless steel frame and providing the opportunity for truly unexpected bathroom and vanity design.

### THERE'S ONLY ONE™ ELECTRIC MIRROR®

Electric Mirror is the global leader in Lighted Mirrors and Mirror TV technology. With unparalleled customer service and amazing innovation, Electric Mirror is the standard of luxury for five-star hotels, upscale commercial projects and designer homes.

#### FEATURES

- E-Life™-8 Years Extended Lamp Replacement Cycle
- Brushed or Polished Stainless Steel Frame
- Reverse Side is Stainless Steel
- Natural Light Color
- HardCoat™ Anti-Corrosion Mirror Treatment
- Stainless Steel Construction
- Environmentally Sustainable
- Energy Efficient
- Proudly Made in The USA
- Patented (US 7,853,414)

#### LIGHTING

- Low-Mercury T5HO Warm Fluorescent (US Made)
- CRI 85
- CCT (K) 3000
- Average Life of 20,000 Hours for Circline Lamps
- 50,000 Cycle Ballast

#### OPTIONS

- Custom Sizes Available
- Add Keen™ Technology
- Add Vive™ Technology
- Diamond Clear™
- Defogger
- LED Lighting

#### SAFETY

- Tested to UL/UL-C 1598 Including Section 16.23
- International Certifications
- Safety Backed Mirror

**PROPRIETARY AND CONFIDENTIAL:** The information contained in this specification is the sole property of Electric Mirror®. Any reproduction in part or in whole without written permission from Electric Mirror® is prohibited.

© 2014 ELECTRIC MIRROR®

## ELITE™ LIGHTED MIRROR

### SPECIFICATION

- Fixture is ceiling mounted. Ceiling must be sufficient in strength to handle weight of the entire unit, approximately 70 lbs.
- Multiple ceiling mounting slots to allow for easy attachment to ceiling stud or reinforced area.
- Power to the unit supplied with MC cable exiting ceiling and entering through chassis knockout.
- Power should be controlled by a light switch.

MODEL NUMBER	DIMENSIONS	POWER REQUIREMENTS	LAMPING
ELI58-27.00x40.00	27" W x 40" H x 1.78" D: 58" H 686mm x 1,016mm x 45mm	110 - 277 VAC, 1.00 - .39 Amps, 110W	2 x Circline T5, 55W
ELI58-27.00x40.00-PS	27" W x 40" H x 1.78" D: 58" H 686mm x 1,016mm x 45mm	110 - 277 VAC, 1.00 - .39 Amps, 110W	2 x Circline T5, 55W

\*Standard finish is brushed stainless steel, polished steel also available (PS)

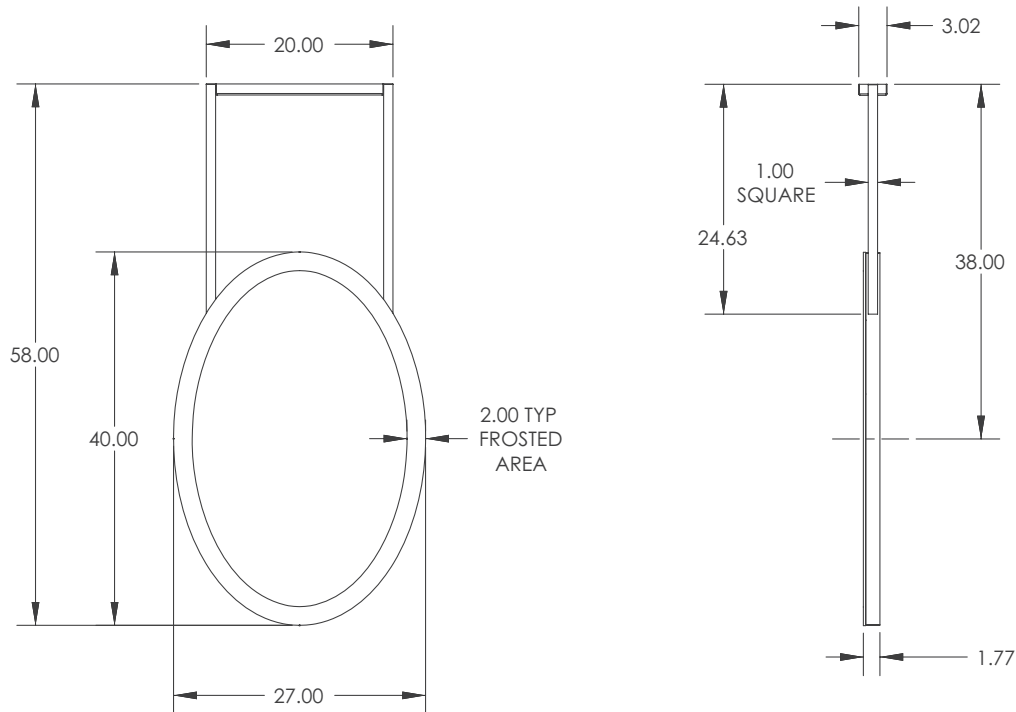

**PROPRIETARY AND CONFIDENTIAL:** The information contained in this specification is the sole property of Electric Mirror®. Any reproduction in part or in whole without written permission from Electric Mirror® is prohibited.

© 2014 ELECTRIC MIRROR®